

# CONCEALEDHINGES

## MATERIAL AND FINISH

HINGE BODY: HOT ROLLED STEEL (SPHC-PO)  
OXALIC-ACID TREATMENT- 4MM THICKNESS

PIN: MEDIUM CARBON STEEL, ZINC PLATED - 6MM

PIN WELDING BUSHES TOP AND BOTTOM: STEEL NATURAL

HINGE WEIGHT: 330GM

IN ACCORDANCE WITH - RoHS.

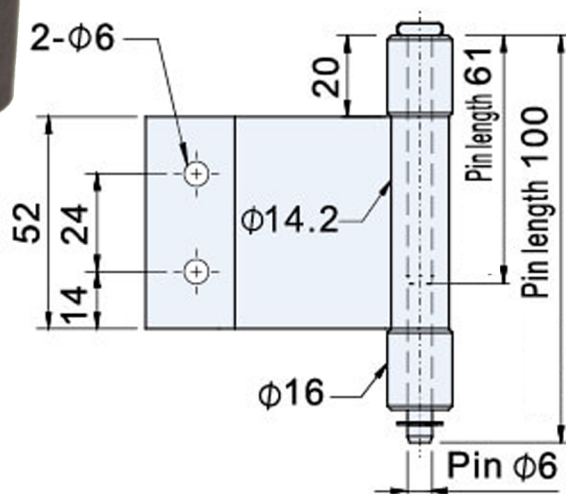

## INSTALLATION

UNIVERSAL LEFT / RIGHT HAND

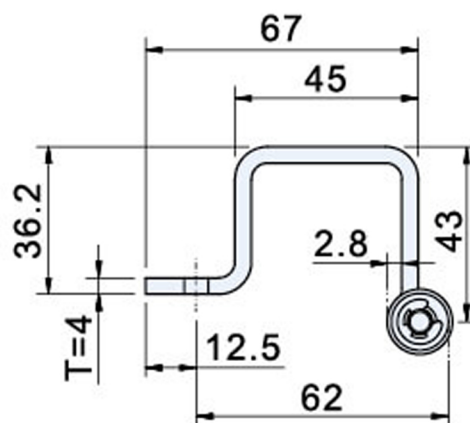
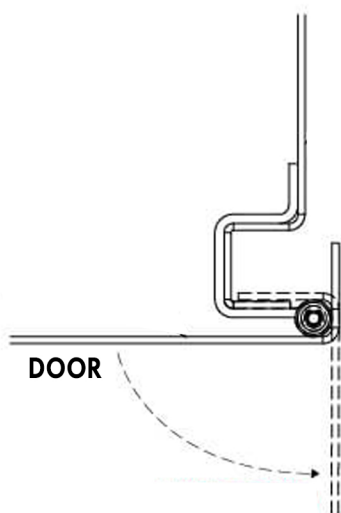
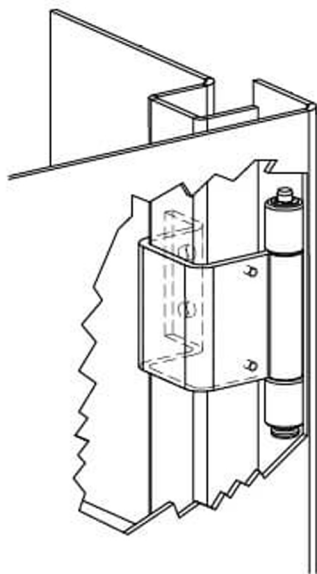

PART NO.

DESCRIPTION

AS-AT-3120L

CONCEALED HINGE 100MM X 74.5 X 4MM PLATE X 6MM PIN UNIVERSAL LEFT / RIGHT HAND



**I.R.S.**

Build With Quality

RUBBER  
HARDWARE  
TAPES  
SEALANTS

1300 767 567

www.indrub.com.au