

AS-703L



AS-702L



AS-701L

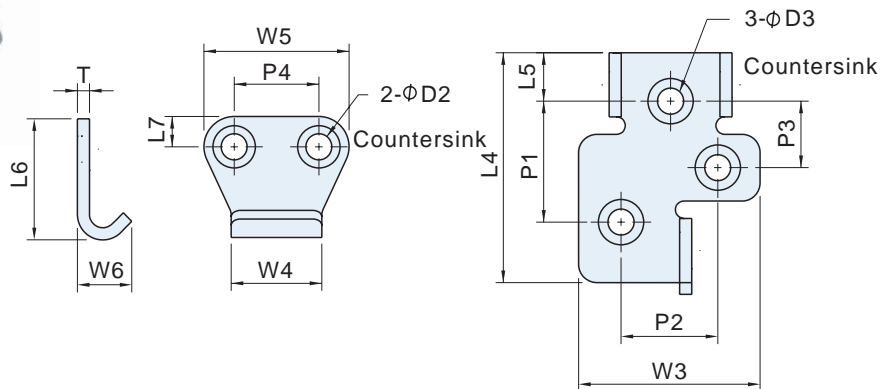
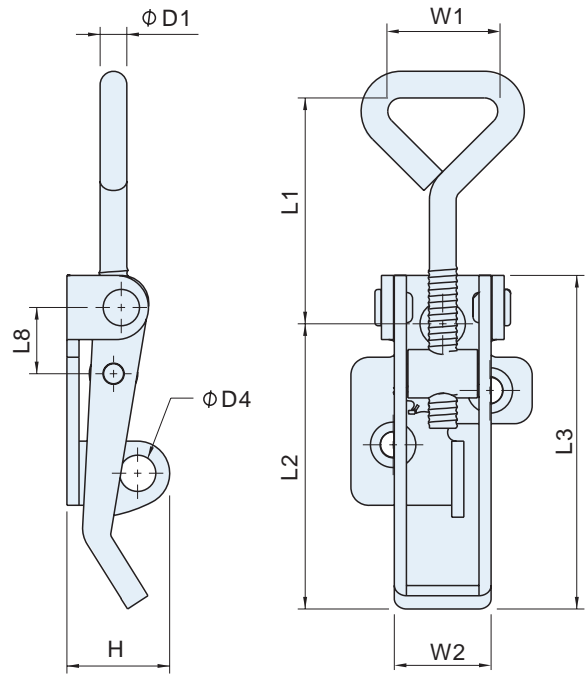

Example of application



MATERIAL AND FINISH

- Cold-rolled Steel (SPCC), Zinc plated.
- Stainless steel (SUS304), Vibration ground.

FEATURES

- Adjustable latch rod, user can adjust the suitable compression force.
- Lock Hole.

SPECIFICATIONS:

Unit:mm

Item No.	Material	Dimensions																				Load capacity (kg)	Weight (g)				
		L1	L2	L3	L4	L5	L6	L7	L8	W1	W2	W3	W4	W5	W6	H	P1	P2	P3	P4	D1			D2	D3	D4	T
AS-701L	SUS304	35~42	47	55	38	8	20	5	11	18.2	16	30	15	24	10.6	17	20	16	11	14	4.4	4.3	4.3	6.0	2	65	51.2
	SPCC																									70	
AS-702L	SUS304	50~65	53	67	50	14	22	6	12	21.4	20	32	17	30	13.3	19	27	18	11	17	5.3	5.3	5.3	6.0	2.5	85	96.2
	SPCC																									80	
AS-703L	SUS304	54~70	85	98	61	12	29	7.5	15	34	30	40	22	45	17	24.5	36	22	19	22	7.0	5.3	5.3	10	3	95	209.8
	SPCC																									90	