

BHC2-32-25 Black Lever Latch (Pop-Lock)

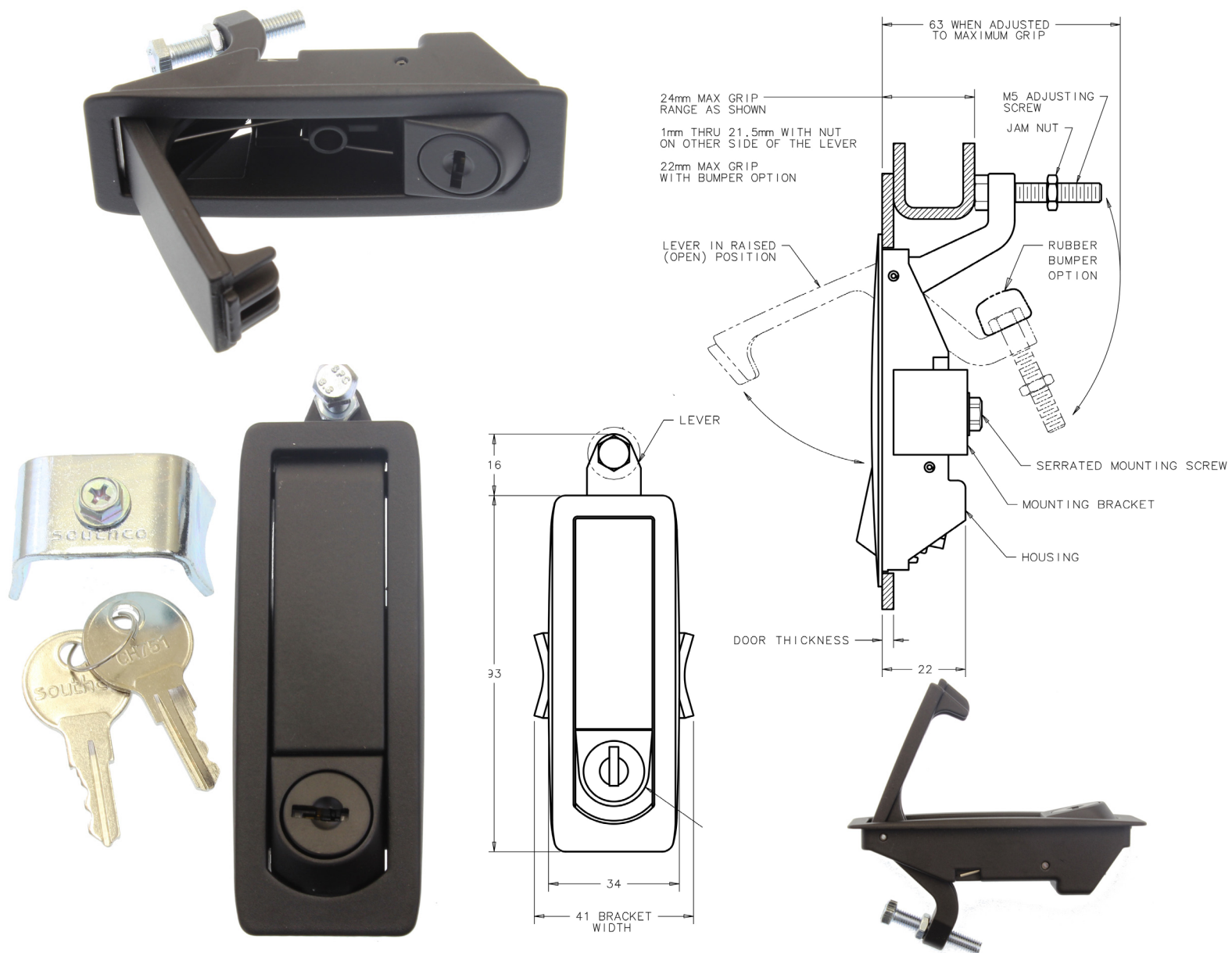

Code	Description
BHC2-32-25	This SOUTHCO lever Latch (Pop-Lock) is a zinc alloy Black powdercoated Locking style lock with an adjustable thread lock coated jam nut. A raised trigger makes access easier from any angle or position.

FOR ENQUIRIES:

Call us on: 1300 767 567

WA Store: 102 Briggs Street Welshpool WA 6106

QLD Store: 2/17 Alexandra Place Murarie QLD 4172

Email: websales@indrub.com.au

Web: www.indrub.com.au



I.R.S.

**RUBBER
HARDWARE
TAPES
SEALANTS**