

HINGES

Heavy Duty Zinc Plate Weld-on Ball Bearing and Pin

D23



**GHG8BALLLHWONS
GHG8BALLRHWONS**



RIGHT HAND SHOWN

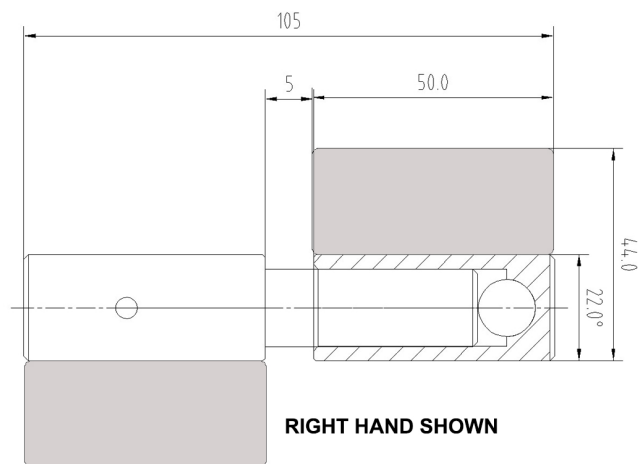

RIGHT HAND SHOWN



**GHG8BALL-L-HWONS
GHG8BALL-R-HWONS**

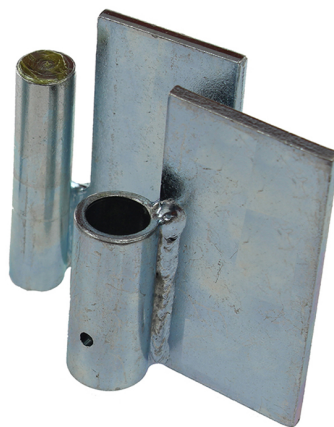

RIGHT HAND SHOWN

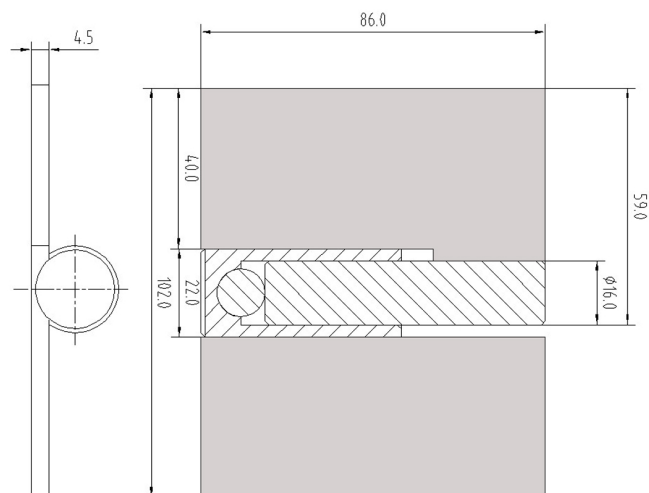

RIGHT HAND SHOWN

PART NO.

GHG8BALLLHWONS	-	GHG8 PIN AND BALL HINGE ZINC PLATED LEFT HAND WELD ON NS 50MM X 20MM X 4.5MM
GHG8BALLRHWONS	-	GHG8 PIN AND BALL HINGE ZINC PLATED RIGHT HAND WELD ON NS 50MM X 20MM X 4.5MM
GHG8BALL-L-HWONS	-	GHG8 PIN AND BALL HINGE ZINC PLATED LEFT HAND WELD ON NS 100MM X 86MM X 4.5MM
GHG8BALL-R-HWONS	-	GHG8 PIN AND BALL HINGE ZINC PLATED RIGHT HAND WELD ON NS 100MM X 86MM X 4.5MM



I.R.S.
Build With Quality

**RUBBER
HARDWARE
TAPES
SEALANTS**

1300 767 567

www.indrub.com.au