

RV Door Lock Installation Guide

a. Unscrew and remove internal handle assembly

b. Install the front / outside assembly into the door panel cut out.

c. Reunite internal handle assembly with out side assembly.

d. Showing door panel face plate

e. Showing door Jam panel face plate

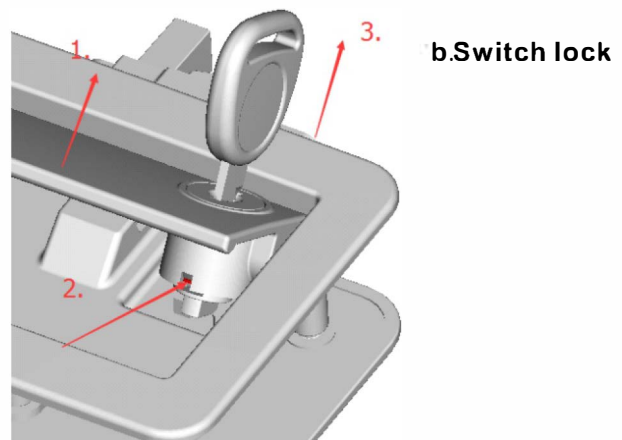
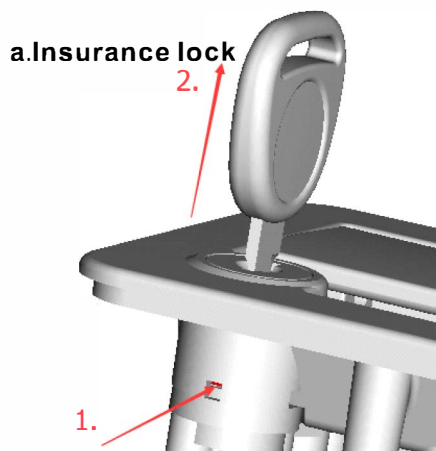
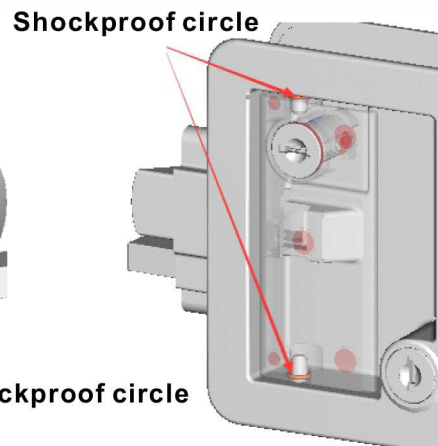
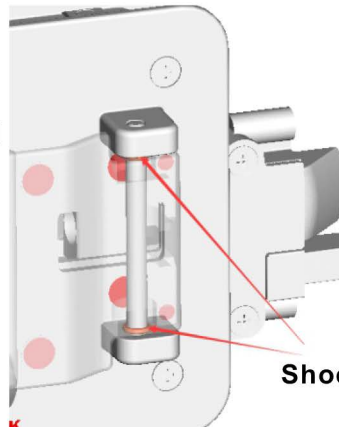
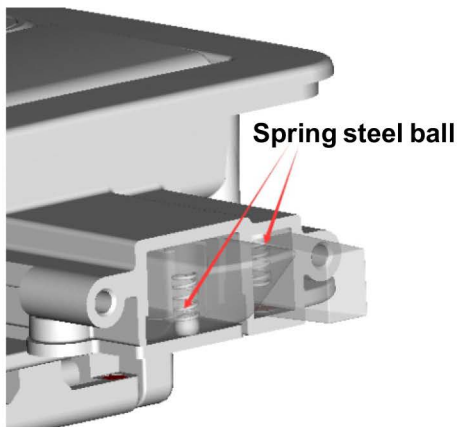
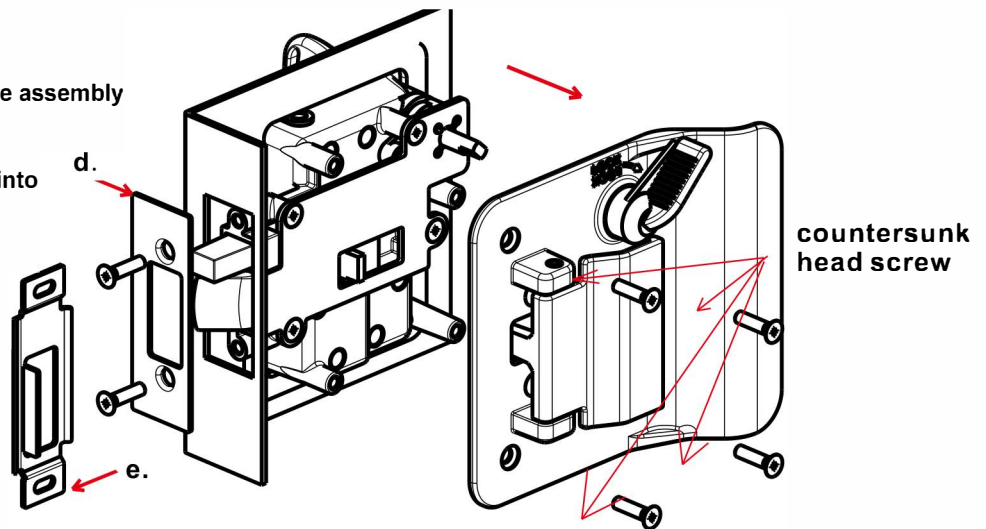

I.R.S.
Build With Quality

RUBBER
HARDWARE
TAPES
SEALANTS

1300 767 567

www.indrub.com.au